



## CATALOG : SYNCHRONOUS ELECTRIC MOTORS

catalogue record : 2

## SYNCHRONOUS ELECTRIC MOTOR REVERSIBLE SMR 300-100

### TECHNICAL DATA

Operating conditions	: ambient temperature $-40^{\circ}\text{C}$ up to $+55^{\circ}\text{C}$ environment IE 33 (T42)
	: voltage 230V, 110V, 24V, 12V frequency 50 Hz, (60Hz)
Speed	: 300 turn/min. for 50 Hz (360 turn/min. for 60 Hz)
Sense of rotation	: possibility of reversing
Power input	: 2 W
Operating position	: arbitrary
Mass	: 0,165 kg
Starting torque	: minimally 9,8 mNm for 50 Hz (minimally 7,8 mNm for 60 Hz)
Synchronic moment	: minimally 9,8 mNm for 50 Hz (minimally 7,8 mNm for 60 Hz)
Dimensions	: diameter 50 mm, length 24 mm without the output shaft output shaft - diameter 1,8 h6 in length 7 mm
Remark	: SMR 300-100 is using in geared motor B 406
Capacitor	: table 2-1

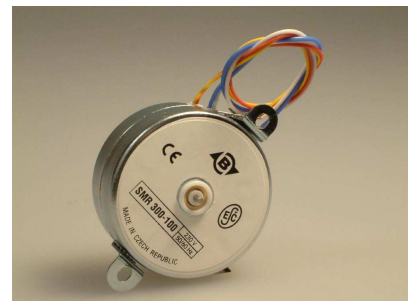

### DIMENSIONAL DRAWING

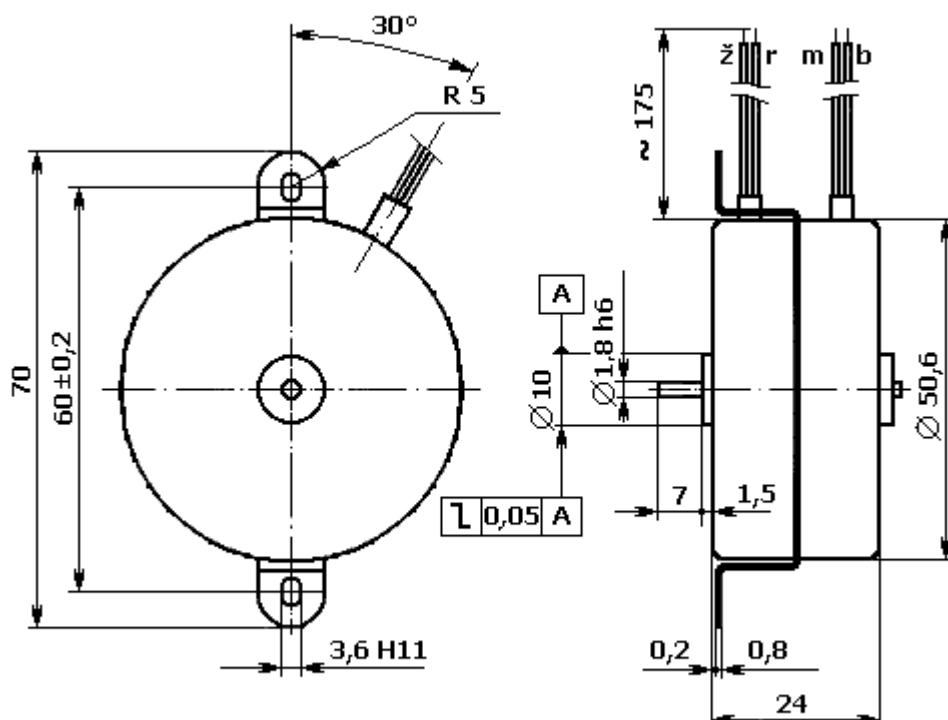

Circumferential run – out in rotation 0,02 mm

Axial clearance of the rotor 0,2 - 1,2 mm

Diameter 10 for centring of the motor, recommended hole diameter for assembly 10 H8.

## VALUE CAPACITOR

Table 2-1

Nominal voltage [V] <sup>1)</sup>	Designation <sup>4)</sup>	Current [mA]	Capacitor C [ $\mu$ F] for 50 Hz <sup>2)</sup>	
230	SMR 300-100-230	8	0,05	<sup>1)</sup> Applicable voltage <sup>2)</sup> The capacitor is a component part of the delivery <sup>3)</sup> Special version <sup>4)</sup> Must be specified in the order
110	SMR 300-100-110	15	0,15	
60 <sup>3)</sup>	SMR 300-100-60	25	0,68	
48 <sup>3)</sup>	SMR 300-100-48	30	1	
24	SMR 300-100-24	60	4	
12	SMR 300-100-12	125	16	

## WIRING DIAGRAM

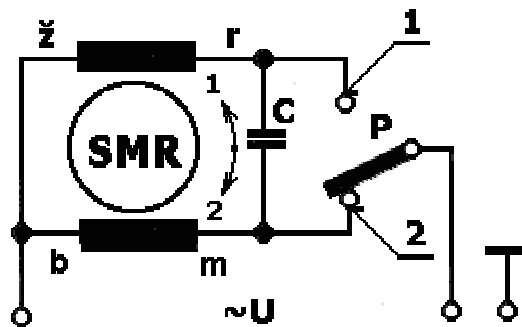

### Sense of rotation (look against shaft):

- 1 - counterclockwise
- 2 - clockwise

### Colour coding of the outlets:

- b - white
- m - blue
- z - yellow
- r - red

**C** - capacitor

**P** - commutator sense of rotation